

MODEL 2300

safety brine valve assembly

SAFETY BRINE VALVE

This control is used primarily as a safety shut off on time fill brine systems.

SOLID BRASS AND MONEL CONSTRUCTION

Quality brass body and monel ball assures long valve life.

POSITIVE SHUT OFF

Monel ball on soft rubber seat provides reliable shut off.

MOUNTED ABOVE BRINE

The valve is mounted above the brine solution to keep it out of the sediment collecting in the bottom of the tank.

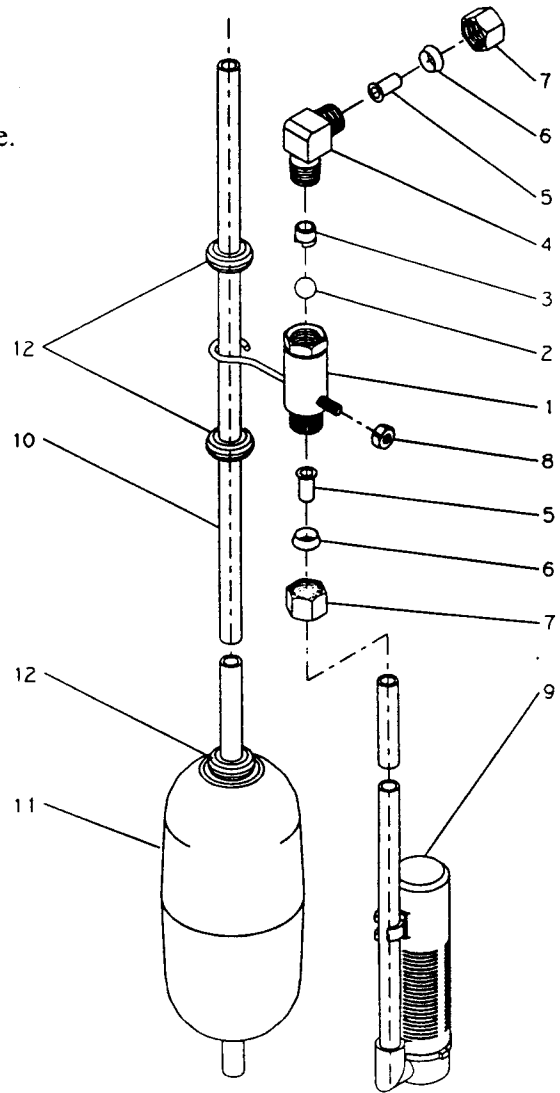

Assembly No.

- 60027-FFA (Fitting facing arm)
- 60027-FFS (Fitting facing stud)
- 60028 (Float)

Item No.	Quantity	Part No.	Description
1	1	60027-00	2300 Safety Brine Valve Body
2	1	10138	Ball, 3/8"
3	1	11566	Ball Stop
4	1	10328	Elbow, 1/4 x 1/4 T
5	2	10332	Insert, 3/8
6	2	10330	Sleeve, 3/8
7	2	10329	Tube Nut, 3/8
8	1	10186	Nut, Hex, 10-32, Nylon
9	1	60002	#500 Air Check
10	1	10149	Float Rod, 30"
11	1	10700	Float Assembly. Blue/White
12	4	10150	Grommet